



4 X 4 A C C E S S O R I E S

Fitting Instructions

Ford Ranger 2023

VW Amarok 2023

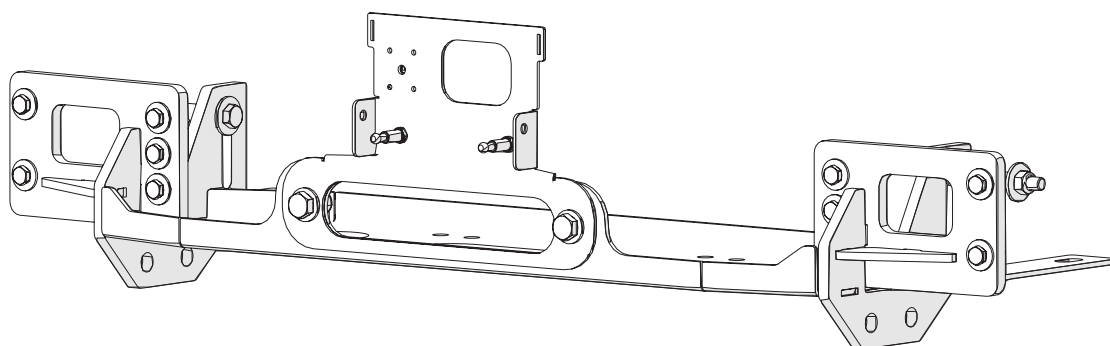

This manual contains the **Ford Ranger** and **VW Amarok** fitting instructions for:

Winch Mount **REF: 48002891**

AFN 4x4 Accessories

Product: **Winch Mount**

Ref: **48002891**

Checklist

3

Product 48002891

Fitting Instructions

4

Step 1

5

Step 2

6

Step 3

7

Step 4

9

Final Result

10

CHECKLIST

- In this section you have a checklist with all parts included for the installation of your AFN product
- This product should be installed as demonstrated in the product fitting instructions
- If verified that any component is damaged, please contact your nearest AFN distributor
- The specified parts will only fit in the models specified by AFN
- Do not modify any component of the product

This checklist is for product **48002891**.

REF.: 48002891

NUMBER	DESCRIPTION	REFERENCE	QTY
1	Winch Mount	47002850	1x
2	Radar Bracket	47002898	1x
3	Ball Stud Lock Nut	46011662	2x
4	Bolt M6x12 STAINLESS STEEL	45001125	2x
5	Bolt M12x25	47002718	2x
6	Washer M12	45001253	4x
7	Nylock Nut M12	45001558	2x
8	Bolt M8x30	45001520	10x
9	Washer M8 (big)	45001267	20x
10	Nylock Nut M8	45001521	10x
11	Bolt M10x100x30	45000241	2x
12	Inner Bushing	46011560	2x
13	Washer M10 (big)	45000010	4x
14	Nylock Nut M10	45000017	2x
15	Shim	46011803	2x
16	Bolt M3x10	45001045	4x
17	Nylock Nut M3	45001043	4x
18	Washer M3	45001041	4x

FITTING INSTRUCTIONS

WARNING:

Before you begin installation, read all instructions thoroughly.
 Proper tools will improve the quality of installation and reduce the time required.

- This product should be installed as demonstrated in the *Product «Fitting Instructions»*;
- The specified parts, will only fit the models specified by **AFN**;
- Do not modify any component of the product;
- It is recommended that this product is installed by specialized and trained personnel;
- AFN doesn't take responsibility for changes made in the vehicle by its manufacturer;
- Work safely and use specialized tools at all times;
- **Always use protective gear.**

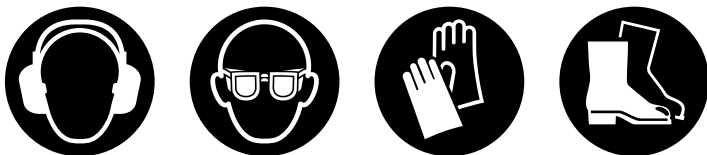

Size	Torque Nm	Torque lbft
M6	9Nm	7lbft
M8	22Nm	16lbft
M10	44Nm	32lbft
M12	77Nm	57lbft

Mouting Time

- 3 Hours
- 2 Persons (recommended)

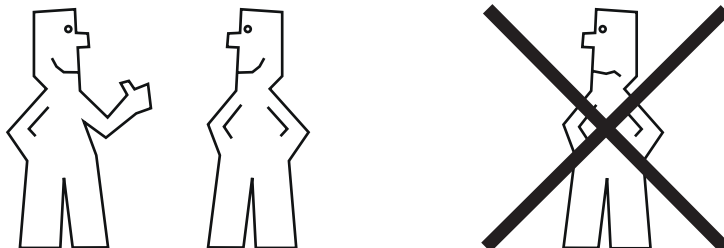

Tools Required

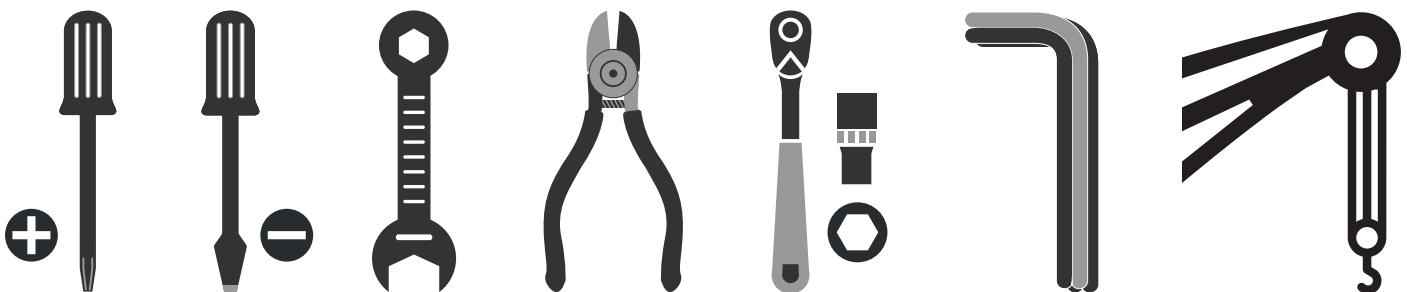

- Screwdriver star head
- Screwdriver flat head
- Wrench
- Wire cutter
- Ratchet wrench
- Allen wrench
- Crane

Step 1

Remove before installing
the winch mount

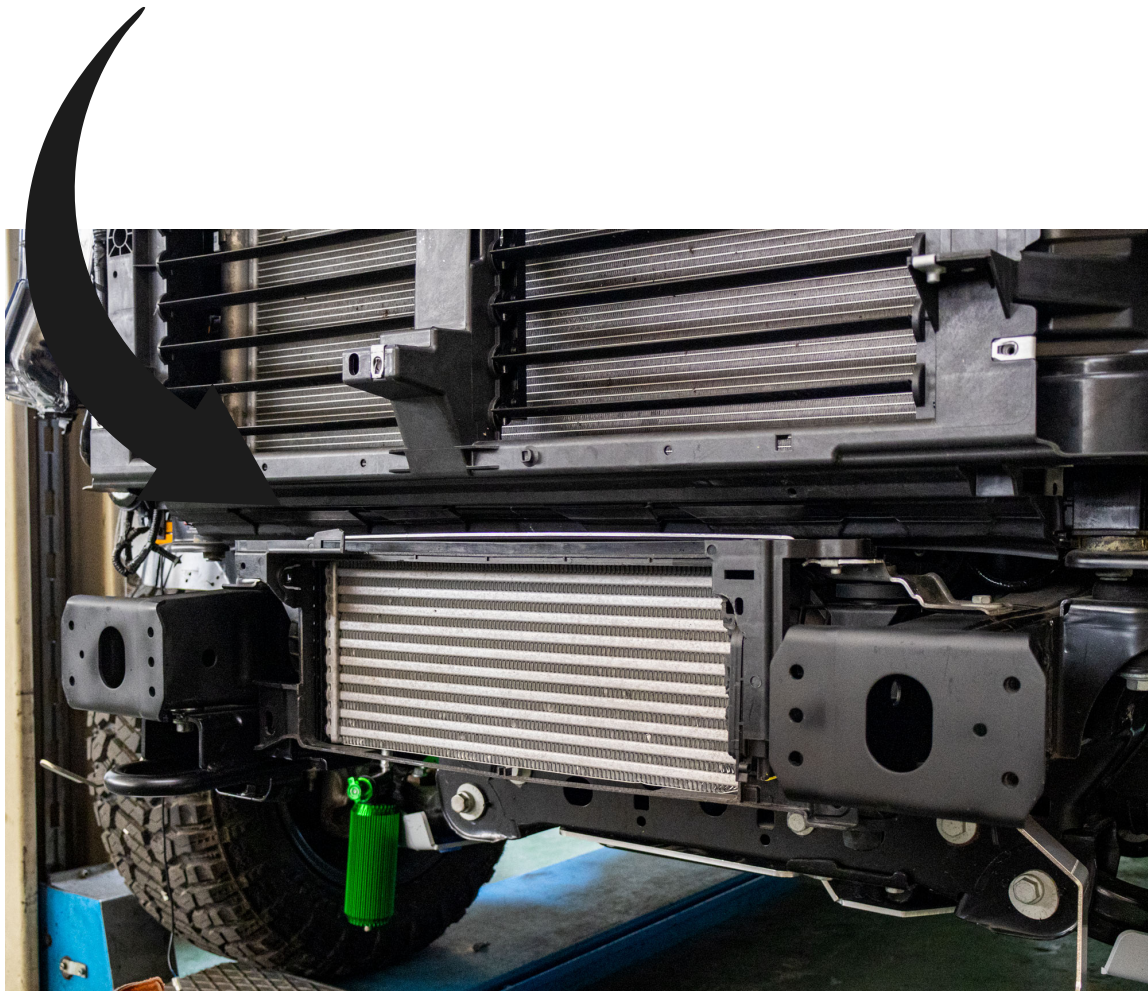

Step 2

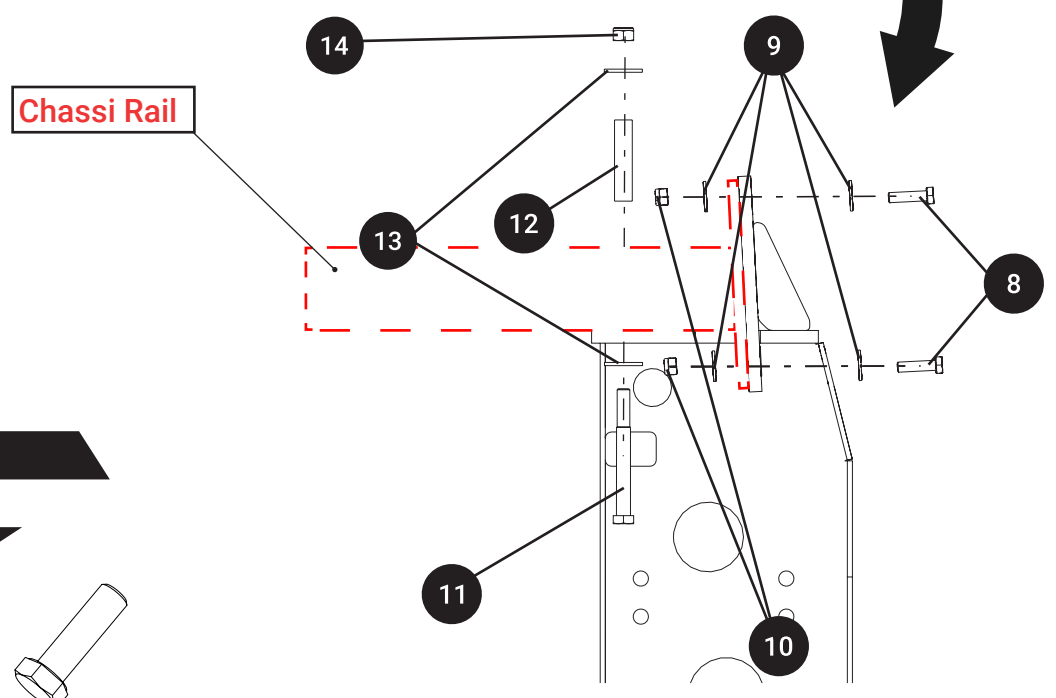
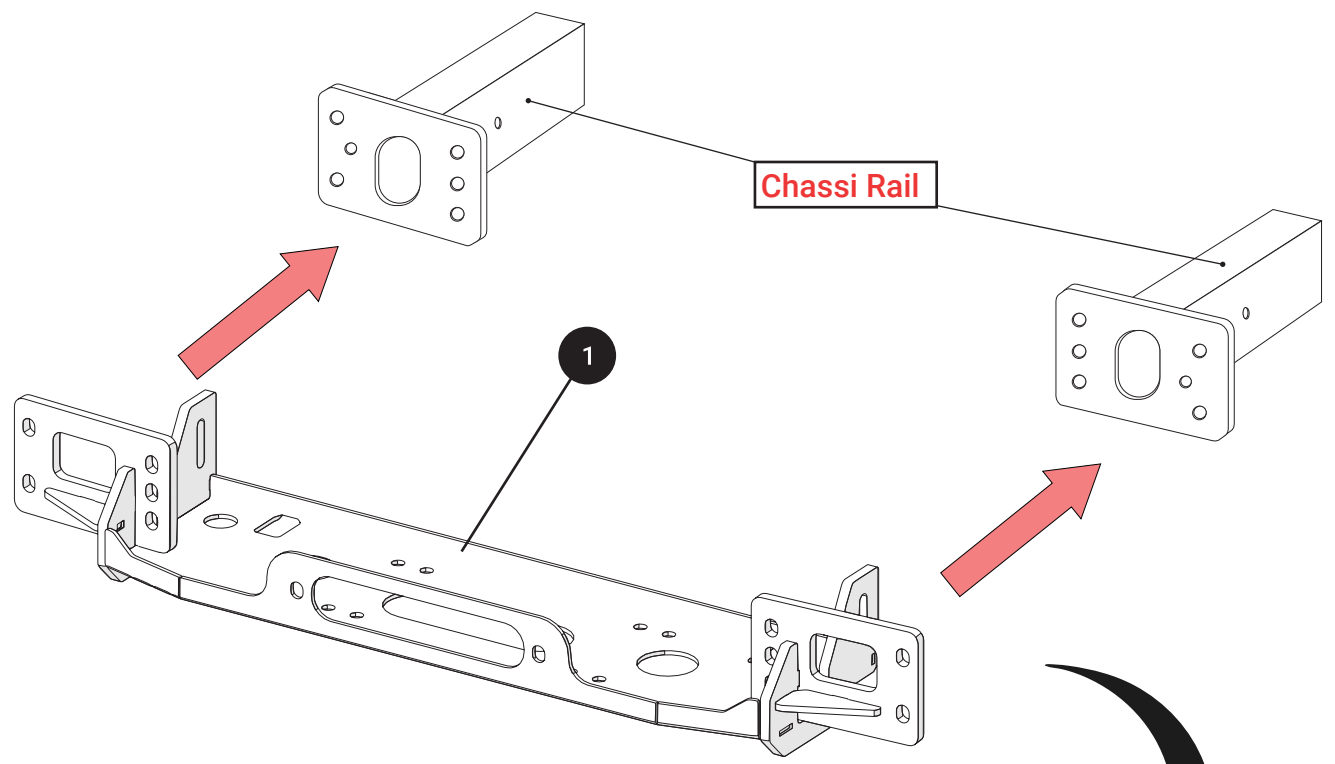

Parts Needed:

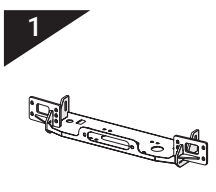

x1 47002850
Winch Mount

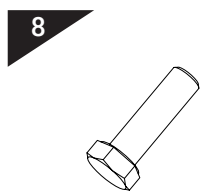

x10 45001520
Bolt M8x30

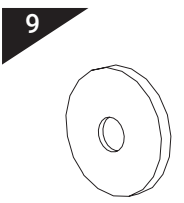

x20 45001267
Washer M8 (big)

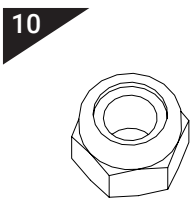

x10 45001521
Nylock Nut M8

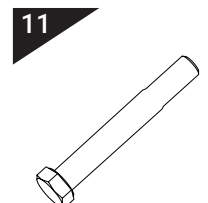

x1 45000241
Bolt M10x100x30

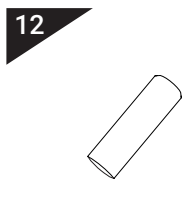

x2 46011560
Inner Bushing

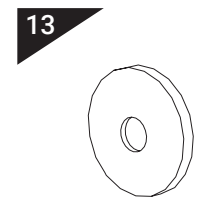

x4 45000010
Washer M10 (big)

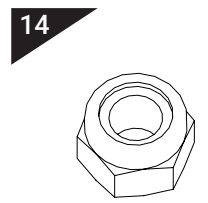

x2 45000017
Nylock Nut M10

Step 3

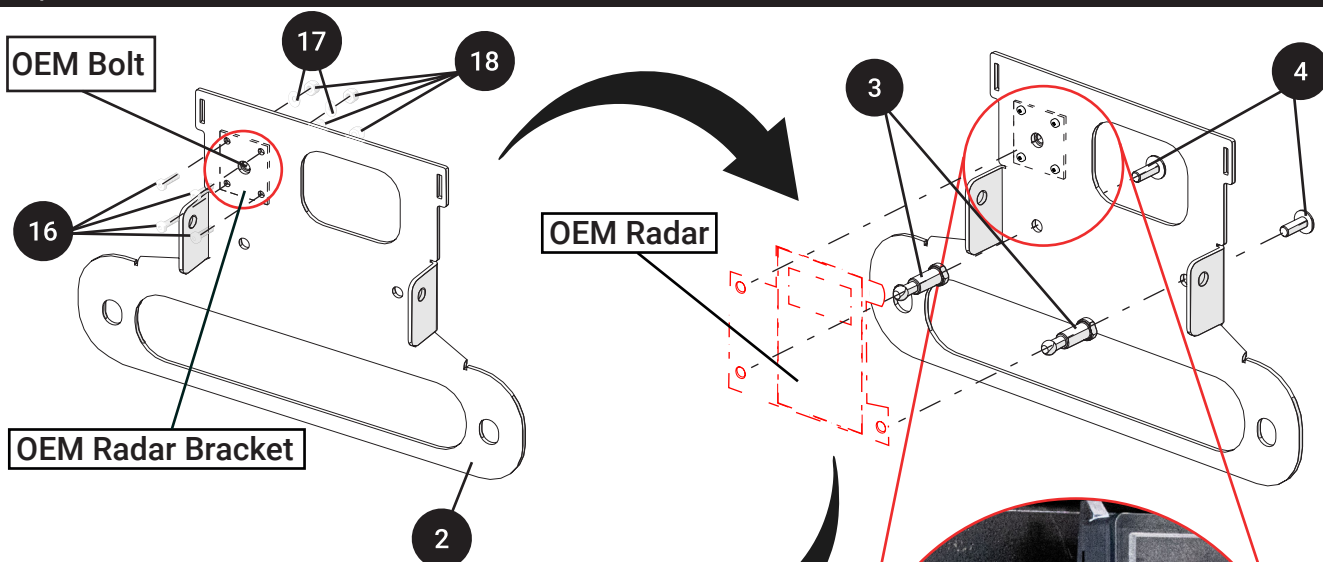

Install the winch

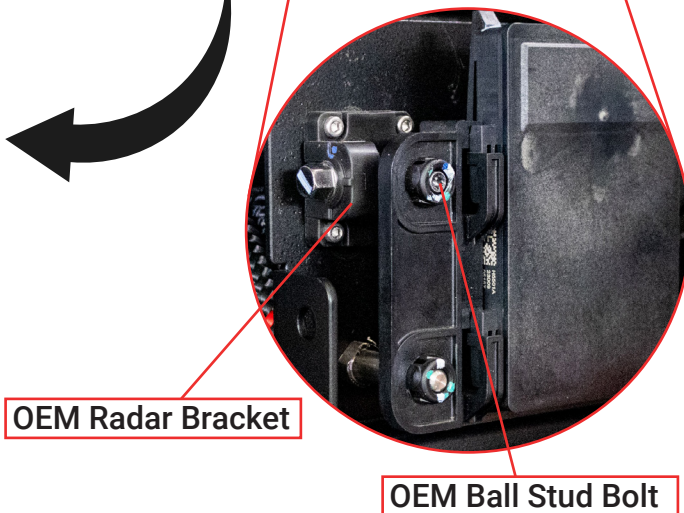

Parts Needed:

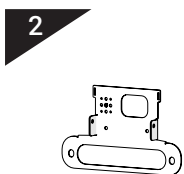

x1 47002710
Radar Bracket

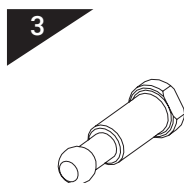

x2 46011662
Ball Stud Lock Nut

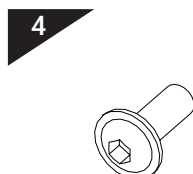

x2 45001125
Bolt M6x12

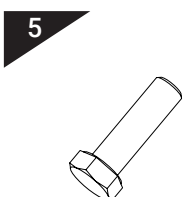

x2 45000065
Bolt M12x25

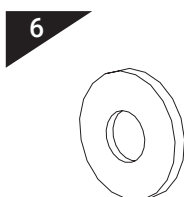

x4 45001253
Washer M12

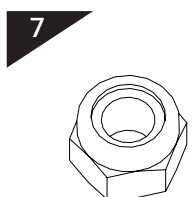

x2 45001558
Nylock Nut M12

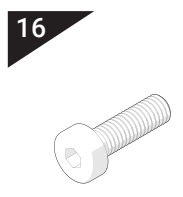

x4 45000065
Bolt M3x10

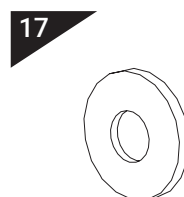

x4 45001253
Washer M3

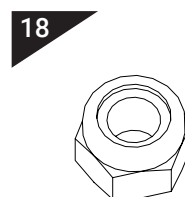

x4 45001558
Nylock Nut M3

Step 4

In this step, you will need to clamp the OEM bumper so you know where to cut.

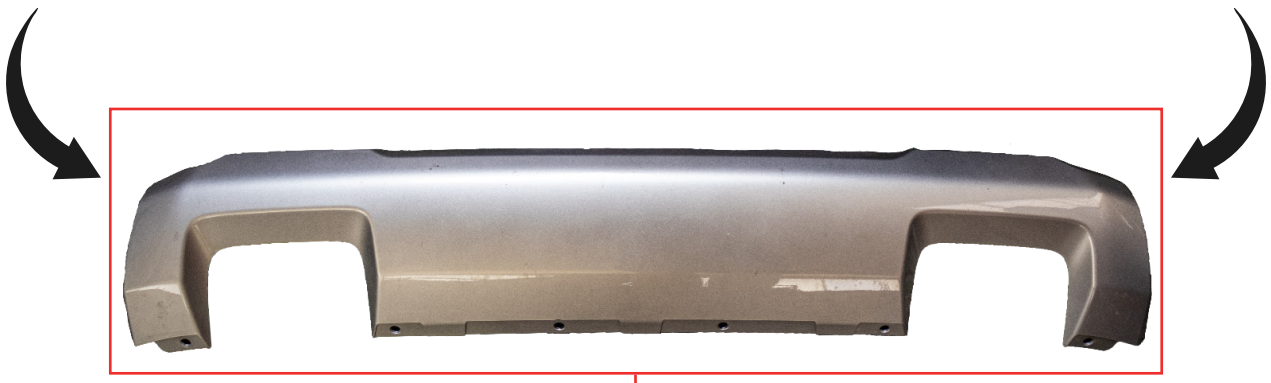
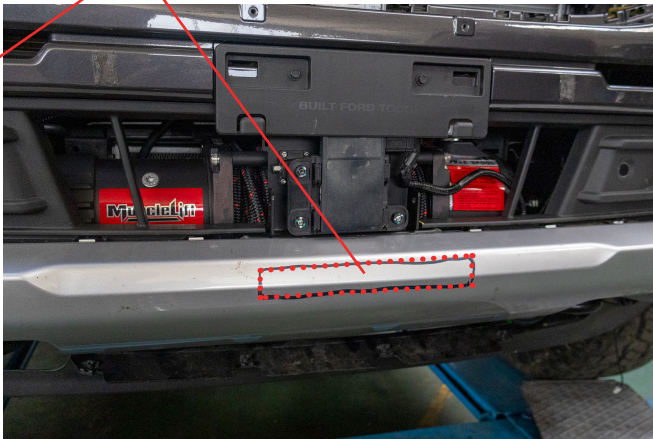
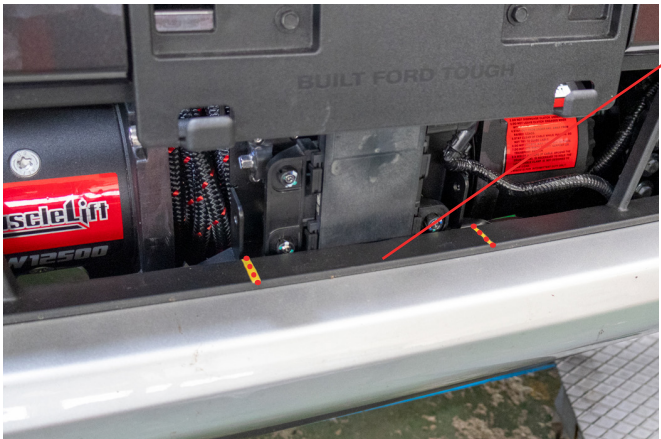

Disassemble this piece, it is much easier to cut. The cuts must be in the middle.



After cut this piece, assemble on the OEM bumper.

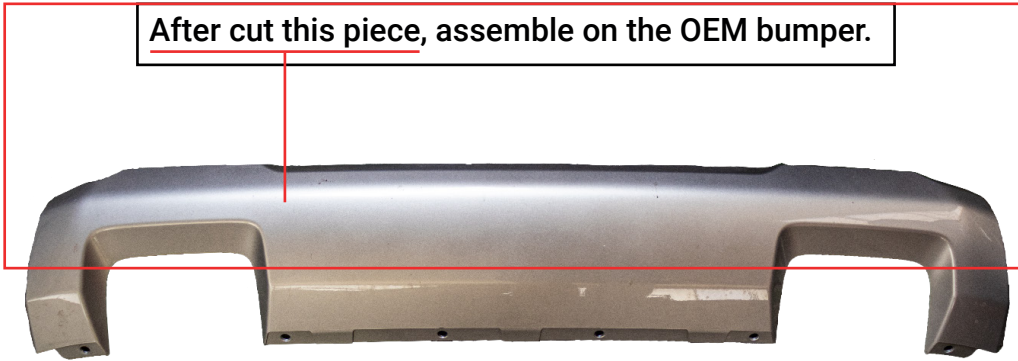

Finally, assemble the OEM bumper.



Final Result